

CERTIFIRE



CERTIFICATE OF APPROVAL No CF 316

This is to certify that, in accordance with
CERTIFIRE's Rules for Certification
The undermentioned products of

MANN MCGOWAN FABRICATIONS LIMITED

4 Brook Trading Estate, Deadbrook Lane, Aldershot, Hampshire. GU12 4XB
Tel: 01252 333601 Fax: 01252 322724

Have been assessed against the requirements of the Technical Schedule(s)
denoted below and are approved for use subject to the conditions
appended hereto:

CERTIFIED PRODUCT

Pyroglaze 30,
Pyroglaze 60,
Pyroglaze Channel &
Pyrostrip 300 Glazing Systems

TECHNICAL SCHEDULE

TS25 Fire Resistant Glass,
Glazing Systems and Materials

Kenneth J Knight
Chairman - Management Council
Page 1 of 8

Issued: 26th October 2004
Valid to: 25th October 2009



Only valid when authentic
CERTIFIRE Seal is in place



CERTIFICATE No CF 316

MANN MCGOWAN FABRICATIONS LIMITED

Mann McGowan Pyroglaze 30, Pyroglaze 60, Pyroglaze Channel & Pyrostrip 300 Glazing Systems

- 1) This Certificate of Approval relates to the contribution to fire resistance of the Mann McGowan 'Pyroglaze 30, Pyroglaze 60, Pyroglaze Channel & Pyrostrip 300' Glazing Systems when used in timber frames or timber door leaves, for periods of 30 or 60 minutes integrity (dependent on system), as defined in BS 476: Part 22: 1987 subject to the undermentioned conditions.
- 2) This product is approved on the basis of:
 - a) Initial type testing
 - b) A design appraisal against TS25
 - c) Product surveillance under BS EN ISO 9001: 2000
 - d) Audit Testing in accordance with TS25
- 3) This Certificate of Approval must be read in conjunction with CERTIFIRE Technical Schedule TS25, Fire Resistant Glass, Glazing Systems and materials.
- 4) The Glazing Systems may be fitted in the manner described in this Certificate of Approval, to previously tested door leaves provided that the particular aspects of the door assembly are maintained. These are described below but are not exhaustive:
 - a) The doorset, including door frame and associated building hardware, should have achieved at least 30 or 60 minutes integrity (dependent on glazing system) when tested or subsequently assessed by one of the laboratories approved by CERTIFIRE as acceptable for this purpose to BS 476: Part 22: 1987.
 - b) If the proposed doorset is to be used in double-leaf configuration, the test or assessment evidence should be applicable to double-leaf configurations.
 - c) Likewise, if the proposed doorset is to be used in the unlatched configuration the available evidence should be applicable to unlatched doorsets.
 - d) The proposed doorset should also have included a glazed aperture or apertures of the intended size, shape, area and number.
 - e) When used to glaze CERTIFIRE approved doorsets which have smaller apertures than allowed in this certificate, the aperture sizes specified in the doorset certificate shall take precedence.
- 5) If glazed in this way the proposed installation of the Pyroglaze 30, Pyroglaze 60, Pyroglaze Channel & Pyrostrip 300' Glazing Systems is not expected to affect the fire resistance performance of the leaf.



CERTIFICATE No CF 316 MANN MCGOWAN FABRICATIONS LIMITED

The glazing system shall be installed within a previously fire tested or CERTIFIRE approved timber based doorsets utilising the following basic specification:

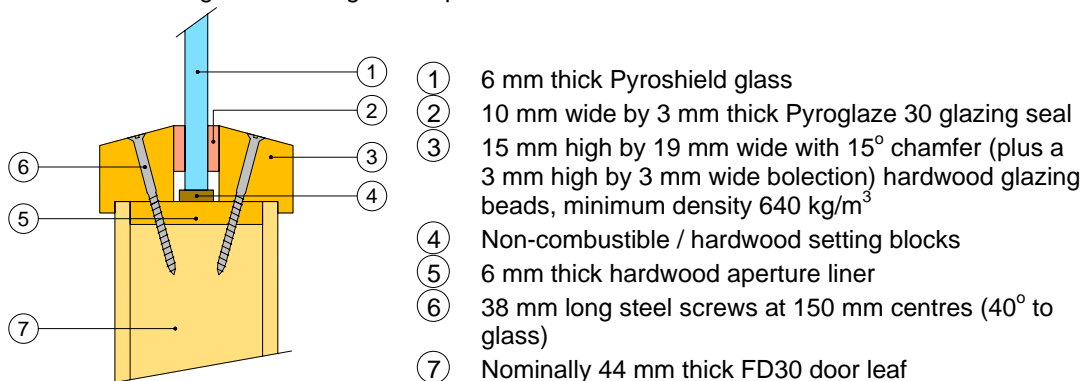

The doorset shall be CERTIFIRE approved or have test evidence for the inclusion of apertures of the proposed dimensions.

This Certificate of Approval relates to the aperture sizes shown in Figure 1 below, when used in conjunction with the above system. The aspect ratio of the glass may be unlimited within these aperture dimensions.

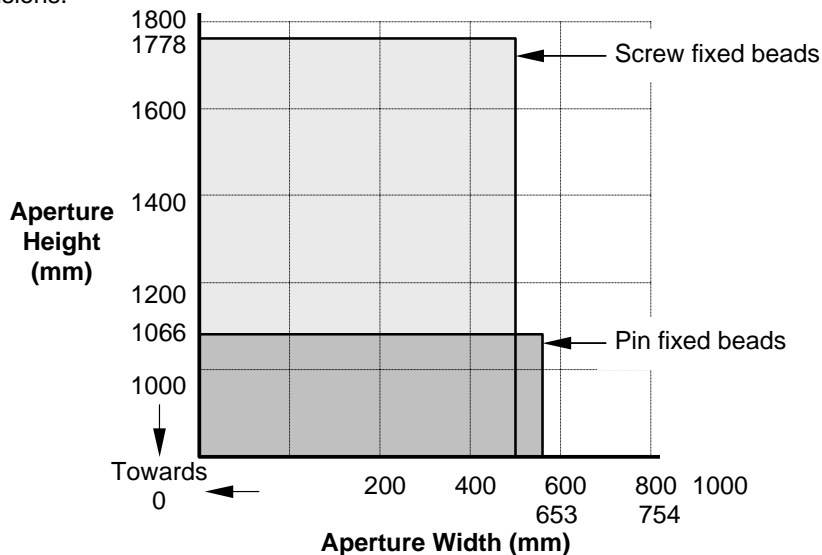

Figure 1. Maximum Permitted Glazed Aperture Dimensions



CERTIFICATE No CF 316 MANN McGOWAN FABRICATIONS LIMITED

Mann McGowan Pyroglaze 30 in timber based doorsets for periods of 30 minutes integrity

The glazing system shall be installed within a previously fire tested or CERTIFIRE approved timber based doorsets utilising the following basic specification:

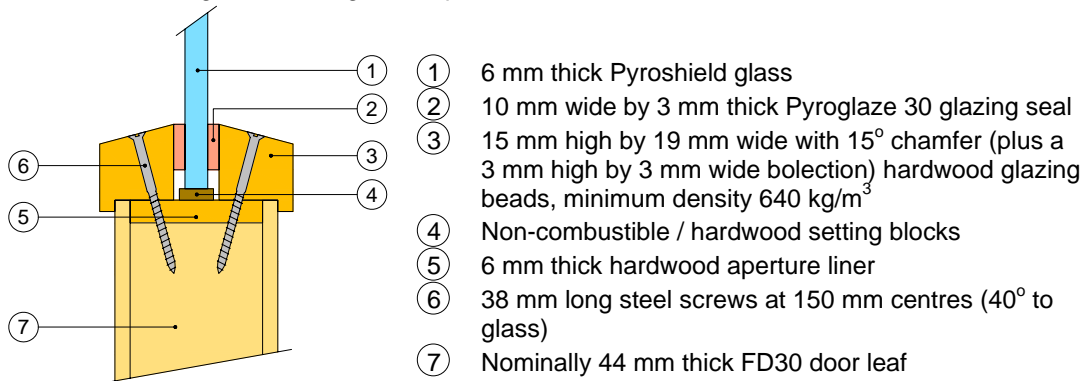

The doorset shall be CERTIFIRE approved or have test evidence for the inclusion of apertures of the proposed dimensions.

This Certificate of Approval relates to the aperture sizes shown in Figure 1 below, when used in conjunction with the above system. The aspect ratio of the glass may be unlimited within these aperture dimensions.

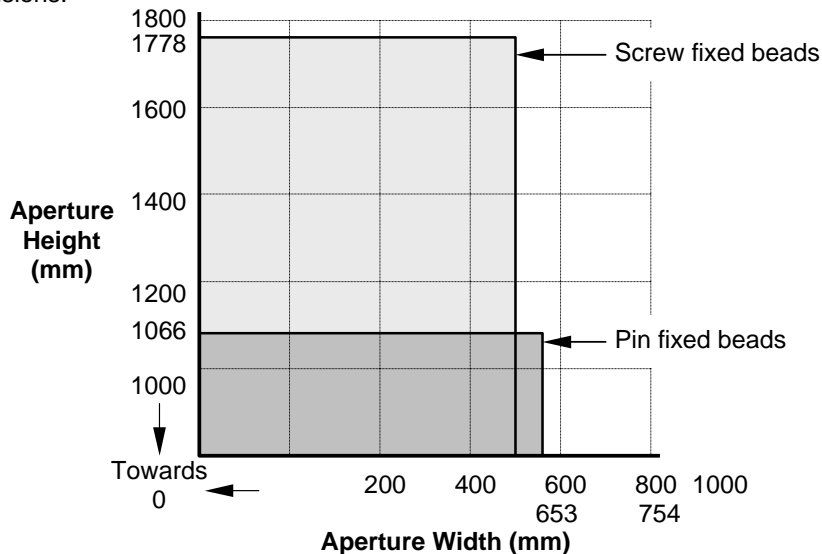

Figure 1. Maximum Permitted Glazed Aperture Dimensions



CERTIFICATE No CF 316 MANN MCGOWAN FABRICATIONS LIMITED

Mann McGowan Pyroglaze 30 in timber framed screens for periods of 30 minutes integrity

For this application the following conditions shall apply:

The glass shall be glazed utilising the following basic specification:

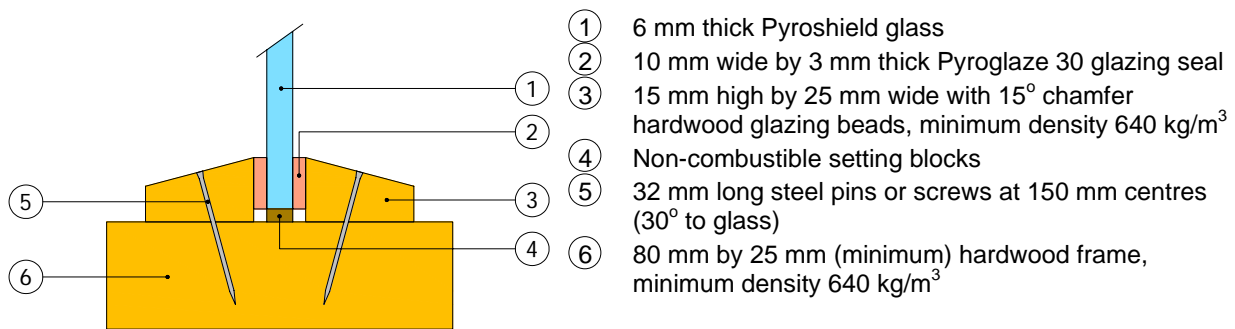

This Certificate of Approval relates to the aperture sizes shown in Figure 2 below, when used in conjunction with the above system. The aspect ratio of the glass may be unlimited within these aperture dimensions.

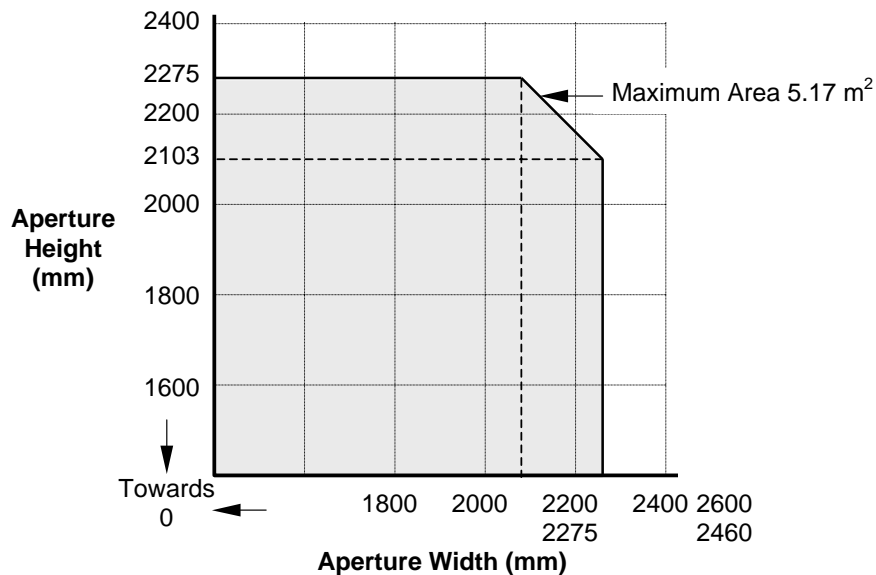

Figure 2. Maximum Permitted Aperture Dimensions



CERTIFICATE No CF 316 MANN MCGOWAN FABRICATIONS LIMITED

Mann McGowan Pyroglaze 60 in timber based doorsets for periods of 60 minutes integrity

The glazing system shall be installed within a previously fire tested or CERTIFIRE approved timber based doorsets utilising the following basic specification:

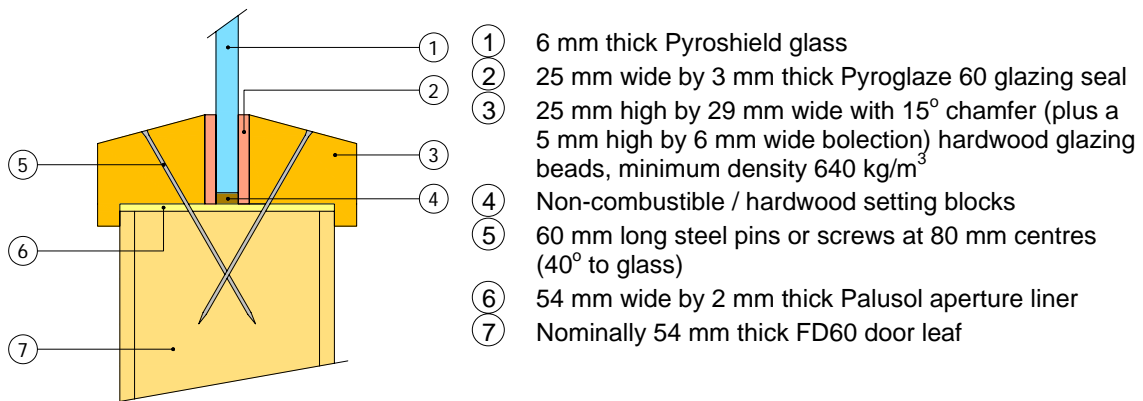

The doorset shall be CERTIFIRE approved or have test evidence for the inclusion of apertures of the proposed dimensions.

This Certificate of Approval relates to the aperture sizes shown in Figure 3 below, when used in conjunction with the above system. The aspect ratio of the glass may be unlimited within these aperture dimensions.

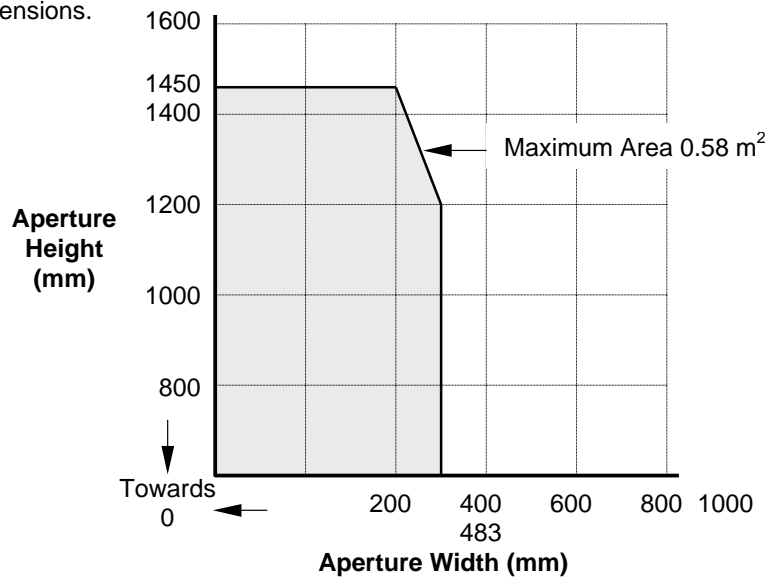

Figure 3. Maximum Permitted Glazed Aperture Dimensions



CERTIFICATE No CF 316 MANN MCGOWAN FABRICATIONS LIMITED

Mann McGowan Pyroglaze 60 in timber framed fixed lights⁽¹⁾ for periods of 60 minutes integrity

For this application the following conditions shall apply:

The glass shall be glazed utilising the following basic specification:

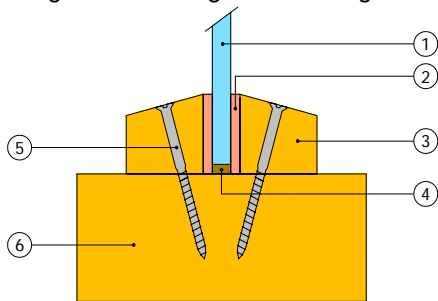

- ① 6 mm thick Pyroshield glass ⁽²⁾
- ② 25 mm wide by 3 mm thick Pyroglaze 60 glazing seal
- ③ 25 mm high by 25 mm wide with 15° chamfer hardwood glazing beads, minimum density 640 kg/m³
- ④ Non-combustible setting blocks
- ⑤ 50 mm long steel pins at 100 mm centres or 56 mm long steel screws at 200 mm centres (30° to glass)
- ⑥ 94 mm by 40 mm (minimum) hardwood frame, minimum density 640 kg/m³

- ⁽¹⁾ Multi-paned glazed screen assemblies (i.e those including transoms/mullions) are not permitted.
- ⁽²⁾ System may also comprise a DGU comprising 6 mm thick Pyran S – air space – 4 mm float glass, where the Pyran S glass is installed to the 'non-fire risk side' of the assembly.

This Certificate of Approval relates to the aperture sizes shown in Figure 4 below, when used in conjunction with the above system. The aspect ratio of the glass may be unlimited within these aperture dimensions.

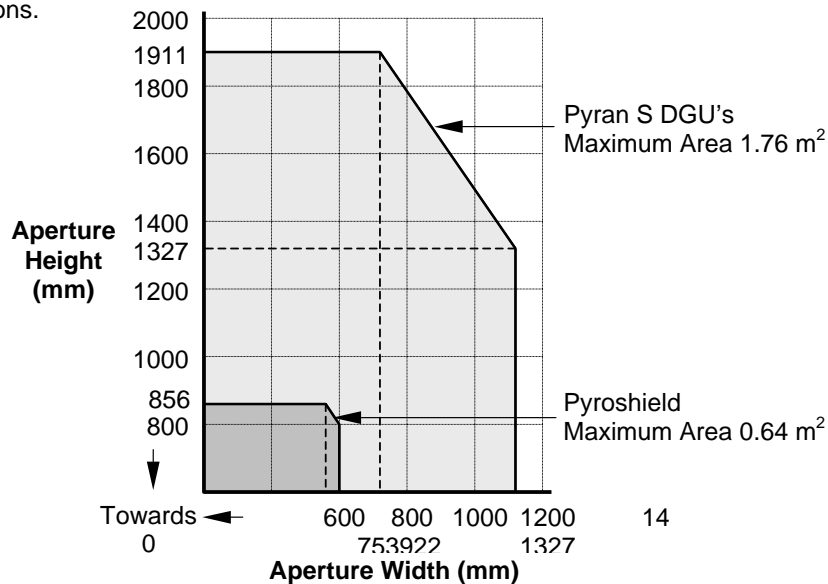

Figure 4. Maximum Permitted Aperture Dimensions



CERTIFICATE No CF 316 MANN MCGOWAN FABRICATIONS LIMITED

Mann McGowan Pyroglaze Channel in timber framed fixed lights⁽¹⁾ for periods of 30 minutes integrity

For this application the following conditions shall apply:

The glass shall be glazed utilising the following basic specification:

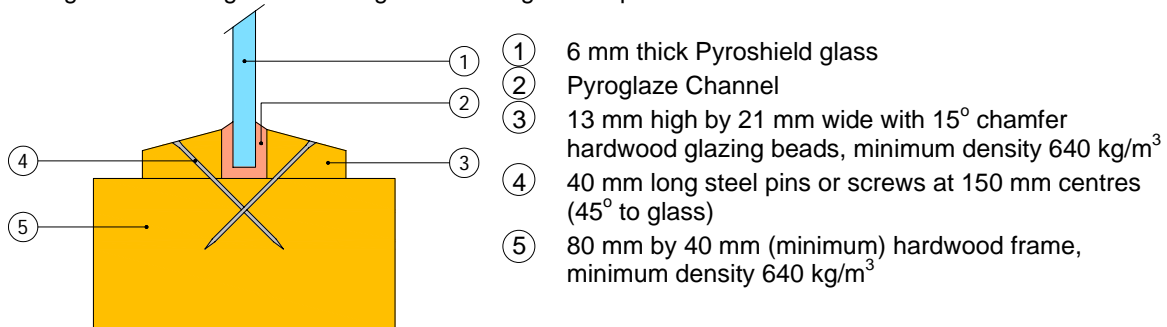

⁽¹⁾ Multi-paned glazed screen assemblies (i.e those including transoms/mullions) are not permitted.

This Certificate of Approval relates to the aperture sizes shown in Figure 5 below, when used in conjunction with the above system. The aspect ratio of the glass may be unlimited within these aperture dimensions.

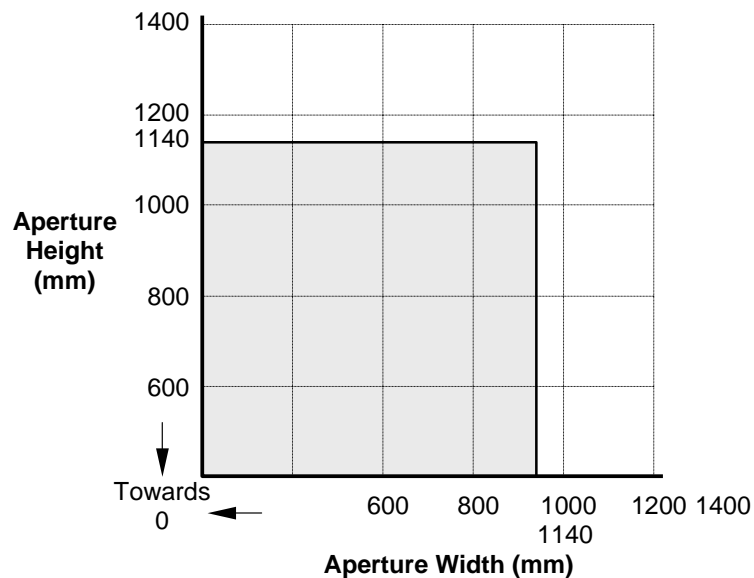

Figure 5. Maximum Permitted Aperture Dimensions



CERTIFICATE No CF 316 MANN MCGOWAN FABRICATIONS LIMITED

Mann McGowan Pyrostrip 300 in timber based doorsets for periods of 30 minutes integrity

The glazing system shall be installed within a previously fire tested or CERTIFIRE approved timber based doorsets utilising the following basic specification:

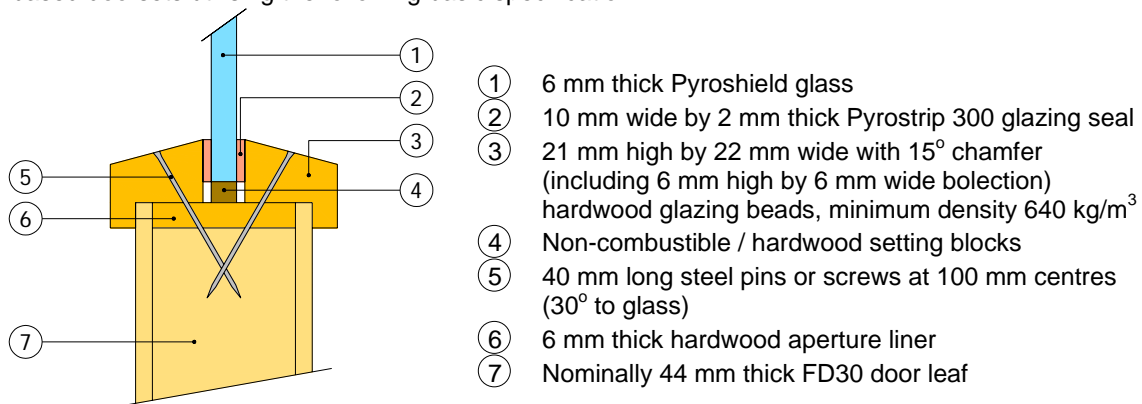

The doorset shall be CERTIFIRE approved or have test evidence for the inclusion of apertures of the proposed dimensions.

This Certificate of Approval relates to the aperture sizes shown in Figure 6 below, when used in conjunction with the above system. The aspect ratio of the glass may be unlimited within these aperture dimensions.

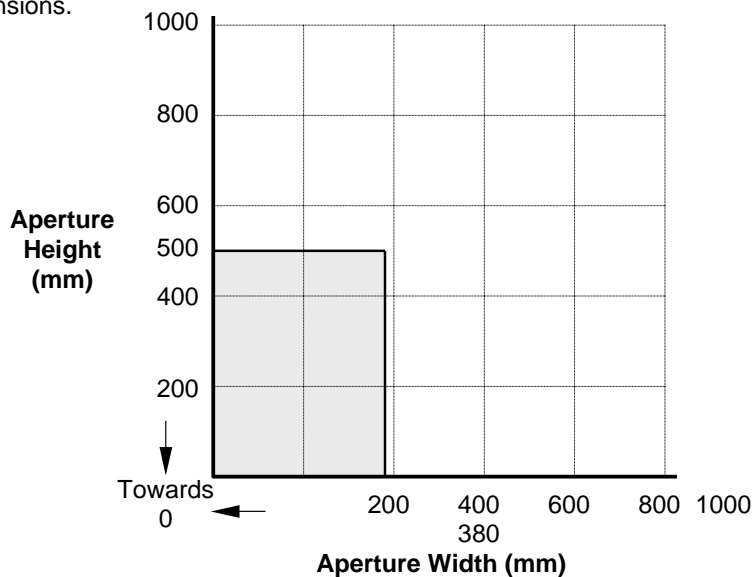

Figure 6. Maximum Permitted Glazed Aperture Dimensions